

# LUSHNA Rainroom

Elegant wooden modular private bathroom in nature.



**CONNECTION TO NATURE**  
skylight window

**TOP NATURAL MATERIALS**  
larch and pine wood

**UNIQUE DESIGN, FULL COMFORT**  
fully equipped hotel bathroom

**WOODEN TOILET**  
toilet, shower, basin, wardrobe

**FOUR SEASONS PRODUCT**  
min 12 cm eco insulation

**COSY**  
small but spacious

A complete glamorous experience in nature with the comfort of a co natural modular bathroom.

Designed for the most demanding glampers who search for an intimate space. The central-space is occupied by a king size bed perfect for romantic indulging with the view on ever-changing drama of mother nature.

## LUSHNA®

# LUSHNA Rainroom

Modular wooden outdoor bathroom



3.60/1.75/2.9 m, 3.6 m<sup>2</sup> net **SIZE**  
massive wood **MATERIAL**  
12 cm wood fibers **ECO INSULATION**

**CONCEPT** modular, mobile  
**ROOF WINDOW** bright and connected to nature  
**ECO FOUNDATION** ground screws (optional)\*

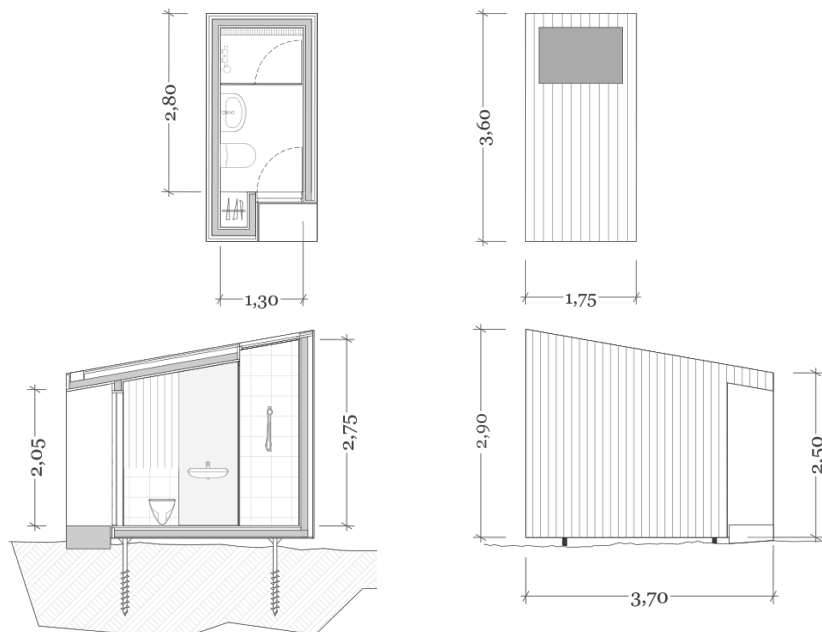

# LUSHNA Rainroom features



wardrobe



electric installation



quality construction,  
insulated for coldest  
winters

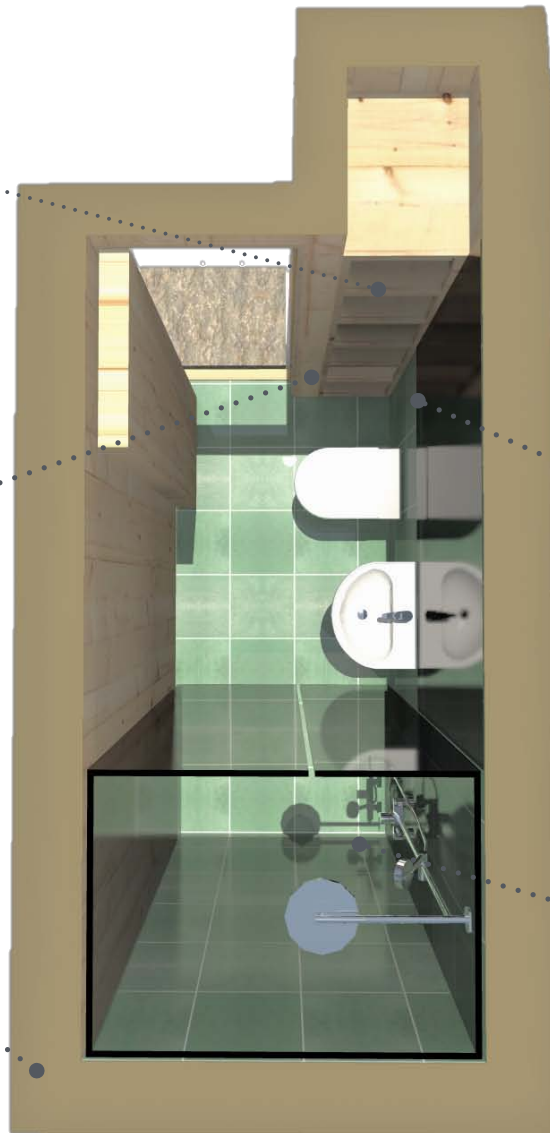

small but spacious  
bathroom



electric heater



glass shower cabin

# LUSHNA Rainroom equipment



skylight window



glass shower cabin



ceramic toilet

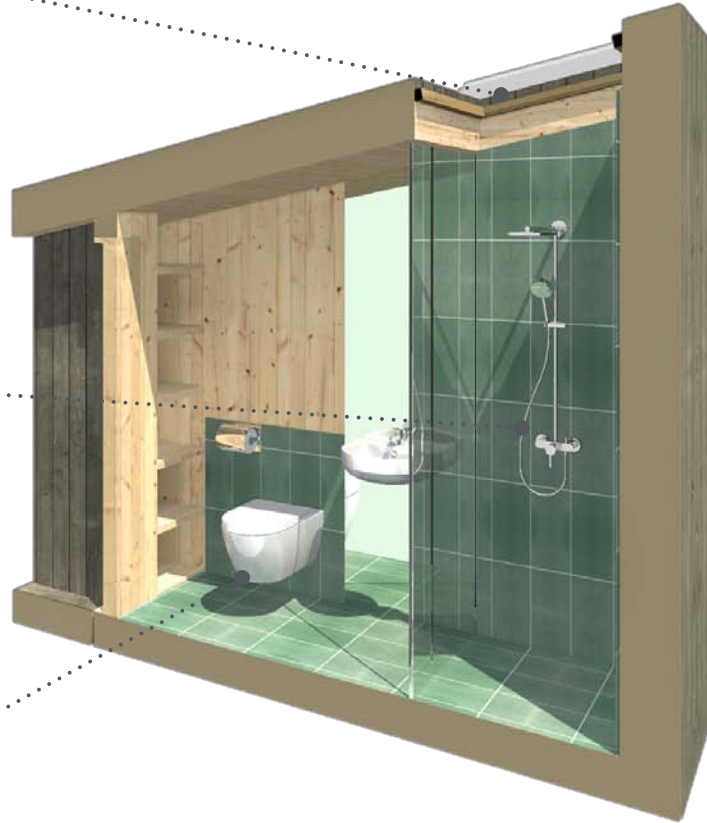

all furniture massive wood MATERIALS  
220/110 V fusebox ELECTRICITY

SEWAGE grid connection or autonomous  
MAINTENANCE none – natural untreated wood



### **Textile quality**

All Textile Elements  
Including zips have up to 2  
years guarantee.



### **Roof quality**

Up to five years guarantee  
on all the roofs.



### **Eco construction**

All Lushna products are  
made from natural and  
ecological materials. The  
use of wood as the main  
material in all Lushna  
products reduce CO2  
emissions considerably.

# LUSHNA Rainroom: Technical specifications

## FLOOR

- Ceramic tiles
- Water resistant barrier Sd = 10m
- Massive wood construction studs
- Insulation wood fibres STEICO flex 12 cm
- Fibre wood board DWD

## WALLS

- Interior wooden cladding in spruce AB
- Ceramic tiles
- Vapour barrier Sd = 10m
- Wooden construction studs
- Insulation wood fibres STEICO flex 10 cm
- OSB board, thick 12mm
- Larch wood battens coloured in black.
- Exterior larch wood cladding

## ROOF

- Interior wooden cladding, tongue / groove thick. 20mm, spruce AB, 1x oiled
- Vapour barrier Sd = 10m
- Massive wood construction studs
- Insulation wood fibres STEICO flex 10 cm
- OSB board, thick 12mm
- 1x EPDM waterproof membrane roofing
- Larch wood battens coloured in black.
- Exterior larch wood cladding

## INTERIOR FURNITURE

- 19 mm massive wood Tilly board thick. 19mm with milled grooves.
- All 2x oiled

## BATHROOM equipment

- Shower glass walls, 10 mm, on hinges
- Sanitary kit: Geberit-Duofix, ceramic WC, ceramic basin, shower plate faucet with a handle.

## ELECTRICITY INSTALLATION

- Robust electrical fuse box with electrical box,
- 2 x power sockets

## LIGHTS

- LED "mirror" light
- General light

## HEATING

- Electric heater 2 kW

## FOUNDATIONS\* (optional)

- Krinner ground-screws with dimensions and length depending on type of soil of location.

# LUSHNA Rainroom: FAQ



## **What is included in the BASIC price per unit?**

Basic price includes the structure, roof, facades, electricity and lightning. Foundations, transport and installation are not included in the basic price. Upon request we can provide a complete solution including our “Ground Screw foundation system”, ecological and concrete free.

## **Is it wired/able to have heat, AC, fan, electricity, water?**

Water, sewage and electrical installation with lighting, connections and sockets are included in the basic price. There is a timer-based ventilation device for ventilating the unit.

## **What preparation for the placement of Vilas needs to be made?**

Lushna provides the plan and specifics for the units’ foundations. Lushna is also offering and installing a complete set up of ecological foundations Krinner Ground Screw Foundation System. We these foundations you don’t need to pre-prepare your land and we can adapt to the topography

## **Time of delivery? LEADTIME?**

We can deliver up to 5 units in 3 months from the order.

## **Foundations**

We use ecological Ground Screws Foundation from Krinner, Germany. We just screw the foundations to ground and place the cabins on the screws and bind them together. In this way no pre-preparation of the location is necessary. We don’t damage the location and cabins can be moved to the other location without major visible signs on the previous location.

## **Warranty**

5 years on the roof and construction and 2 years on the textile parts.